



Comhairle Cathrach & Contae Phort Láirge
Waterford City & County Council

19th February 2024

MQ/PB/G456

Planning Department,
Waterford City & County Council,
Menapia Building,
The Mall,
Waterford.

**Re: Consent to request planning consultation with Waterford City & County Council
on Council owned lands at Kilbarry, Cork Road, Waterford**

To Whom it concerns,

The Property Management Department of Waterford City & County Council hereby consents to McCutcheon Halley Chartered planning consultants on behalf of Noel Frisby Construction Limited making an application to enter planning consultations with the Council for a Large-Scale Residential Development on a site fronting on to the Cork Road, Kilbarry Road and Ballybeg Drive at Kilbarry, Cork Road Waterford on lands partly owned by Waterford City & County Council as per attached maps.

This letter is not consent to commence any works but is purely for planning application purposes only.

Further to the above if the planning application is successful, please revert to me regarding land disposal terms if required.

Please note any land disposal is subject to the consent of the elected members of Waterford City & County Council.

Yours sincerely,

Mary Quigley,
Administrative Officer,
Property Management Department,
Menapia Building,
The Mall,
Waterford.

LAND OWNERSHIP M-01

659759.6171

65929.6171

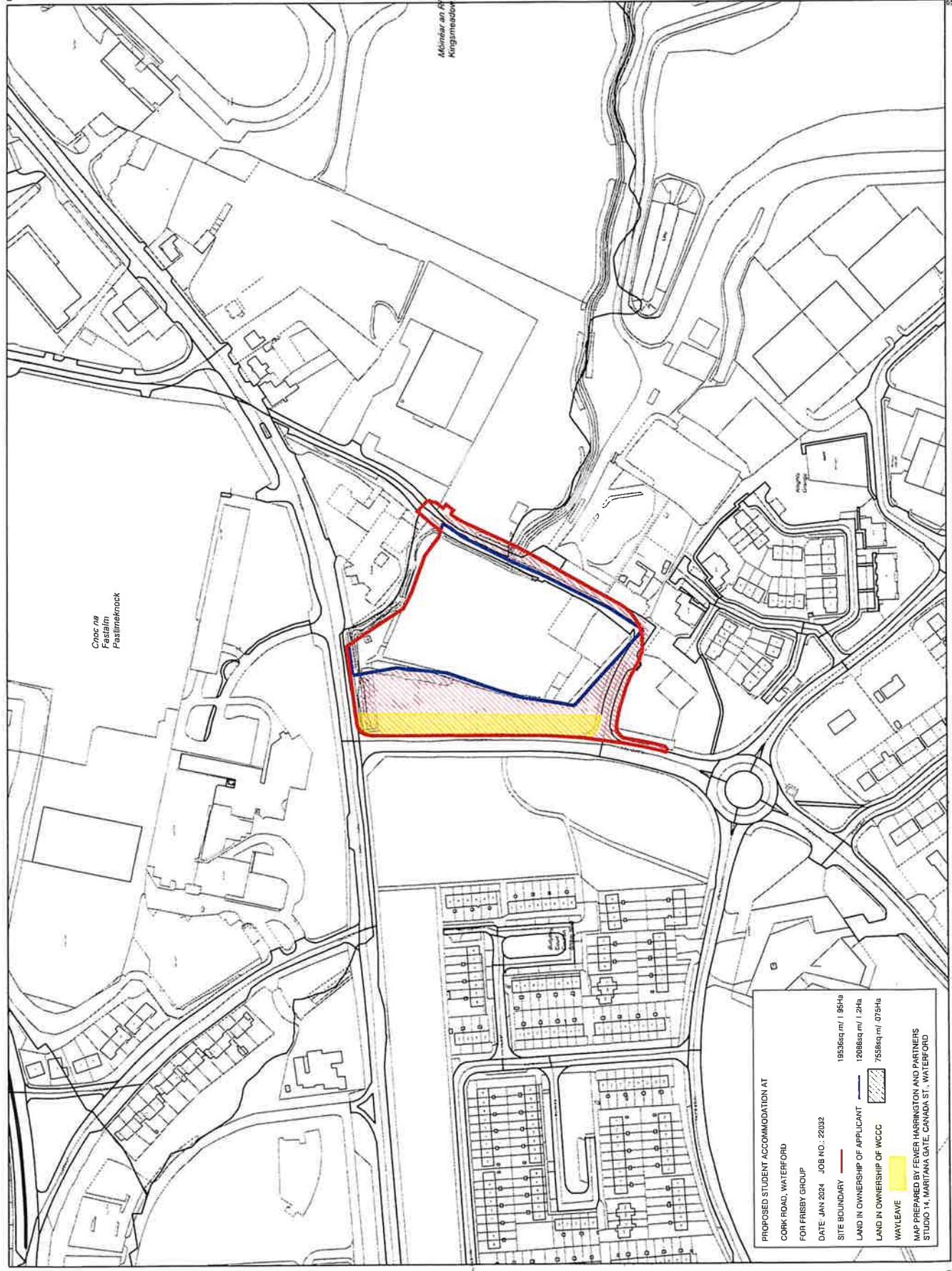

PROPOSED STUDENT ACCOMMODATION AT
CORK ROAD, WATERFORD

DATE: JUN 2024 JOB NO.: 2022

SITE BOUNDARY 19536sq m / 1.85Ha

LAND IN OWNERSHIP OF APPLICANT 1208sq m / 1.2Ha

LAND IN OWNERSHIP OF WCC 7558sq m / 0.75Ha

WAYLEAVE

MAP PREPARED BY FEWER HARRINGTON AND PARTNERS
STUDIO 14, MARITANA GATE, CANADA ST., WATERFORD

810866.0023

Description
Digital Landscape Model (DLM)

Author / Source
Geomatics Survey Ireland (GSI)

Data Source / Reference
PRIME2

File Format
AutoCAD DWG (DWG_2013)

File Name
v_5033742_1.dwg

City / Town / Area of Interest (AOI)
LX.LY: 65929.6171, 610351.0023
ULX.LY: 65929.6171, 610351.0023
URX.LY: 65929.6171, 610351.0023

Projection / Spatial Reference
Projection: PRIME25_NAD_17
Centre Point Coordinates
X: Y: 633334.8171, 610358.523

Scale
Map Series / Map Sheet
1:1000 (570) 1-3
1:1000 (570) 1-4
1:1000 (570) 1-5
1:1000 (570) 1-6

Date / Revision Date
Date: 29-Jun-2022

Source Data Reference
SDALS: HMAAA.V:154.113

Product Version
Version: 1.4

License / Copyright
Geomatics Survey Ireland Terms of Use apply
Please see: www.geomatics.ie/terms

© Ordnance Survey Ireland 2022

Complete and published by Ordnance Survey
Belfast, Phoenix Park, Dublin 8, Ireland

Unauthorised reproduction in whole or in part
without the express written permission of Ordnance
Survey is prohibited and is a criminal offence.

All rights reserved. No part of this publication
may be copied, reproduced or transmitted in any
form or by any means without the prior written
permission of the copyright owners.

The representation on this map of a road, track
or boundary is not evidence of the existence of a
right of way.

Ordnance Survey reserves the right to alter the
information shown on any map without notice.

© Sunbheasath Ordnas Enann 2022

Area Inmhuilí Agas arna hiontú ag
Sunbheasath Ordnas Enann. Páirc an
Phionnsaigh, Béal Átha Cliath 8, Éire

Saibhéal atreagráth neamhdhúshláithe dochaibhéal
Sunbheasath Ordnas Enann agas hiontú
na hÉireann.

Gairt iontú na hiontúcháin. Ní ceadúnúcháin ag
Sunbheasath Ordnas Enann. Páirc an
Phionnsaigh, Béal Átha Cliath 8, Éire

Ábairt gairt iontúcháin neamhdhúshláithe dochaibhéal
Sunbheasath Ordnas Enann agas hiontú na hÉireann.

Ní hiontúcháin iontúcháin ná iontúcháin a bhaineann
le hiontúcháin iontúcháin a bhaineann le hiontúcháin
iontúcháin iontúcháin iontúcháin iontúcháin iontúcháin

610351.0023

610351.0023

